

KGEB Exhaust valve

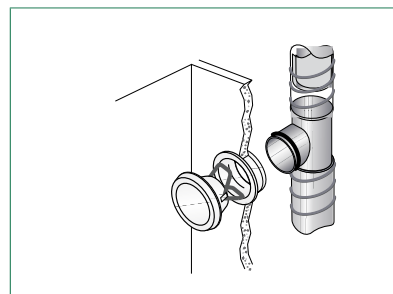
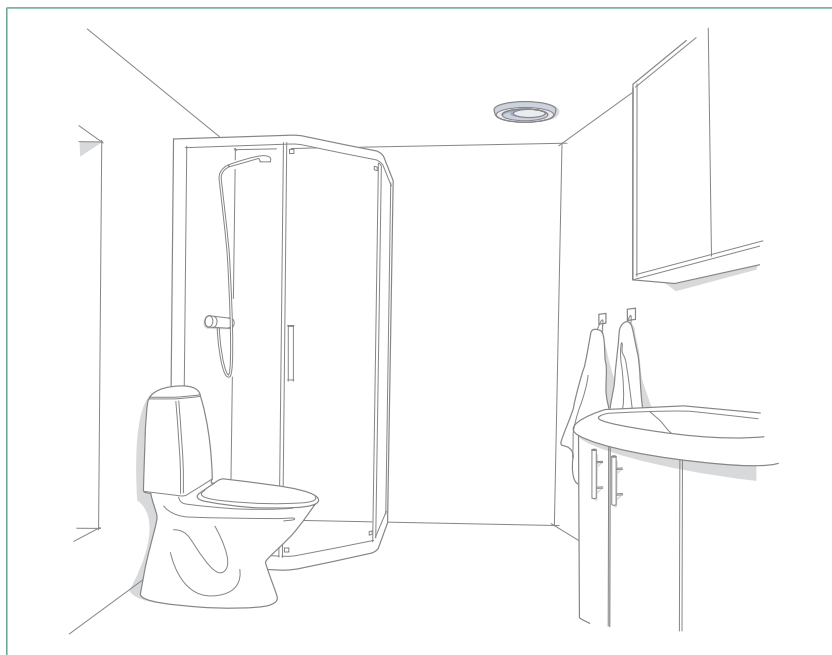

The KGEB exhaust valve is suitable for use in mechanical ventilation systems. The valve can be wall mounted or ceiling mounted and its air flow is simple to adjust. The KGEB has a low noise level, even if the pressure drop is high, and it has good natural sound attenuation.

Quick Selection

Size	Connection alternative	Air flow range l/s at sound level		
		25 dB	30 dB	35 dB
KGEB-100-C	T-piece	16	19	23
	Mounting ring	20	24	27
	Angle duct	14	16	19
KGEB-125-C	T-piece	22	25	28
	Mounting ring	29	34	38
	Angle duct	16	20	23
KGEB-160-C	T-piece	42	50	58
	Mounting ring	47	55	64

Specifications

- CleanVent coating as standard
- Low noise level, even if the pressure drop is high
- Good natural sound attenuation
- Both for new installation and renovation
- Manufactured of steel

Product code example

Exhaust valve KGEB-100-C

Mounting ring KGEZ-01

Air flow, pressure drop, sound level
Size 100 with T-piece

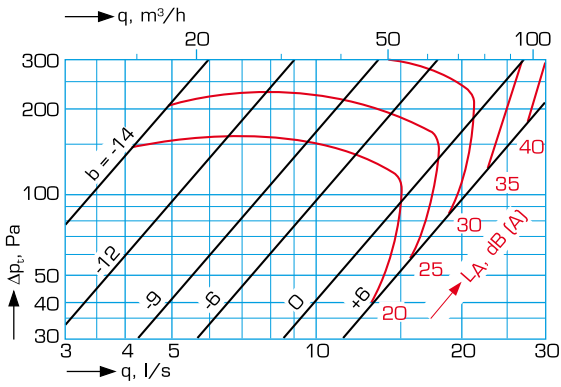

Size 125 with T-piece

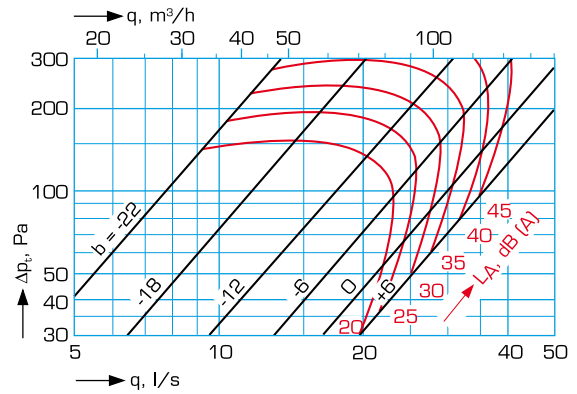

Size 100 with mounting ring

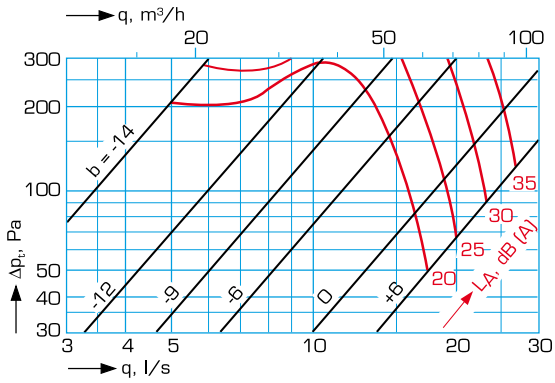

Size 125 with mounting ring

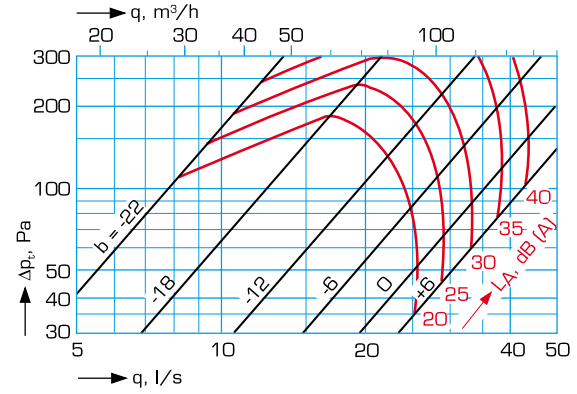

Size 100 with angle duct

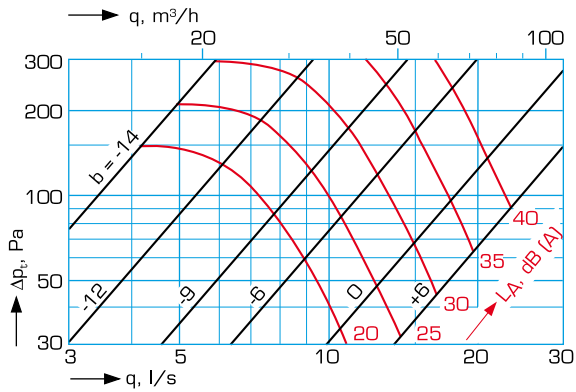

Size 125 with angle duct

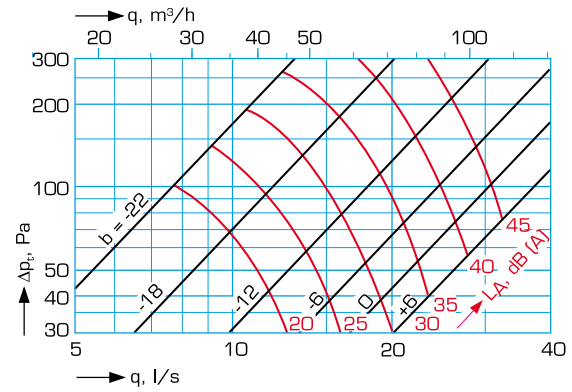

Air flow, pressure drop, sound level Size 160 with T-piece

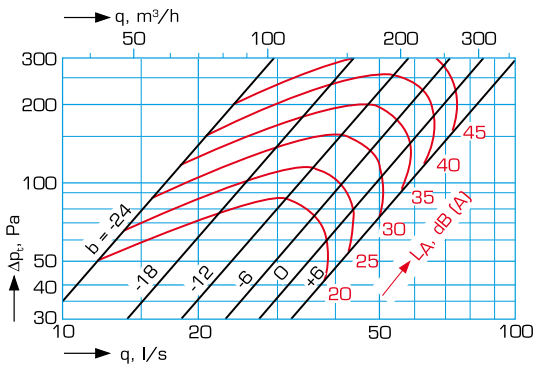

Size 160 with mounting ring

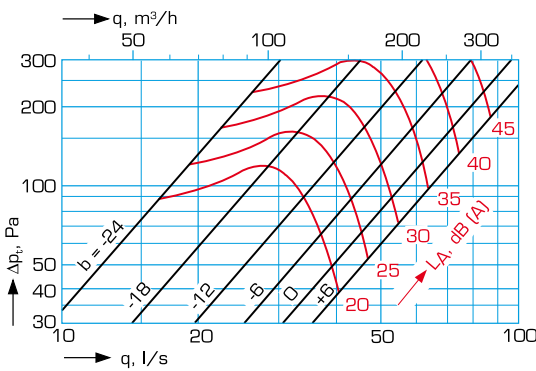

Acoustical data

Sound power level

KGEB	Correction of sound level in dB at octave bands, middle frequency, Hz							
	63	125	250	500	1000	2000	4000	8000
100	10	6	5	1	-2	-4	-7	-12
125	17	2	3	-1	-1	-4	-8	-12
160	18	4	3	0	1	-4	-12	-14

Sound attenuation

KGEB-100-C

Connection	Sound attenuation in dB at octave bands, mean frequency, Hz							
	fitting KGEZ	63	125	250	500	1000	2000	4000
01-100	25	22	21	20	14	18	9	10
05-100	25	22	21	20	14	18	9	10
43-100	30	27	23	17	16	19	12	13

KGEB-125-C

Connection	Sound attenuation in dB at octave bands, mean frequency, Hz							
	fitting KGEZ	63	125	250	500	1000	2000	4000
01-125	24	20	17	15	11	12	7	7
05-125	24	20	17	15	11	12	7	7
43-125	29	25	19	12	13	13	10	10

KGEB-160-C

Connection	Sound attenuation in dB at octave bands, mean frequency, Hz							
	fitting KGEZ	63	125	250	500	1000	2000	4000
01-160	22	18	16	12	14	10	9	8
05-160	22	18	16	12	14	10	9	8

Installation

Valve KGEB connected to a mounting ring

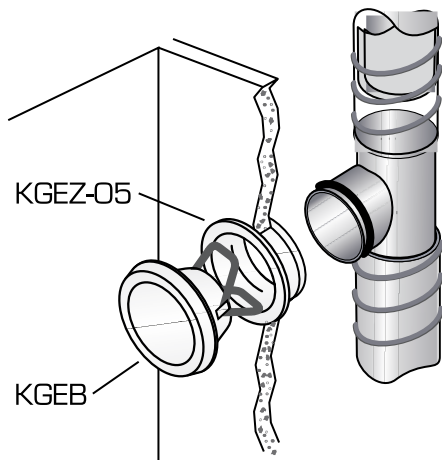

Valve KGEB connected to an angle duct

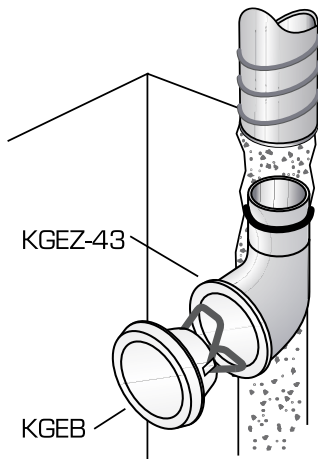

Adjustment

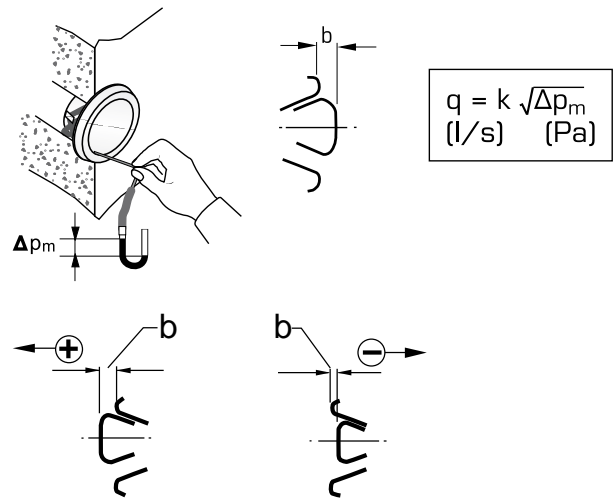

100	b	-11	-9	-6	0	+6	+9
	k-factor	0,39	0,56	0,82	1,36	1,9	2,2
125	b	-22	-18	-12	-6	0	+6
	k-factor	0,88	1,3	1,8	2,4	2,9	3,4
160	b	-24	-18	-12	-6	0	+6
	k-factor	1,8	2,5	3,1	3,9 *	4,6 *	5,4 *

* Applicable for KGEB produced after 01.01.2003

Dimensions and weight

Exhaust valve KGEB

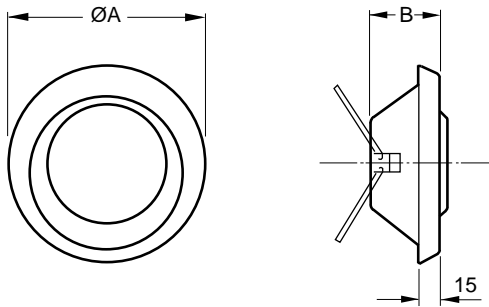

Size	A [mm]	B [mm]	Weight [kg]
100	130	45	0.3
125	155	56	0.4
160	190	65	0.6

Mounting ring KGEZ-01, insertion conn. / Mounting ring KGEZ-05, fit-on conn.

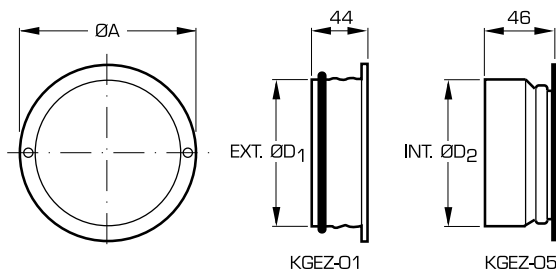

Size	A [mm]	D ₁ [mm]	D ₂ [mm]	Hole size Ø [mm]	Weight [kg]
100	123	99.3	100	110	0.10
125	149	124.3	125	135	0.10
160	185	159.3	160	170	0.16

Angle duct KGEZ-43

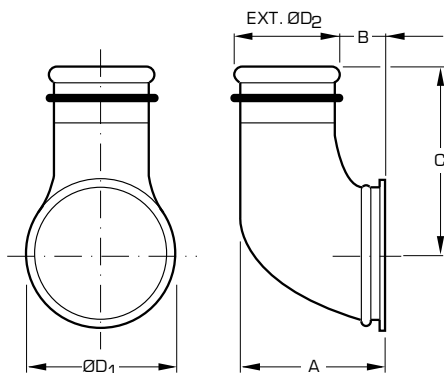

Size	A [mm]	B [mm]	C [mm]	D1 [mm]	D2 [mm]	Weight [kg]
100 - 080	120	39	148	125	79.3	0.4
100 - 100	140	39	98	125	99.3	0.4
125 - 100	146	45	120	140	99.3	0.5
125 - 080	115	36	162	131	79.3	0.4

Mounting frame KGEZ-12

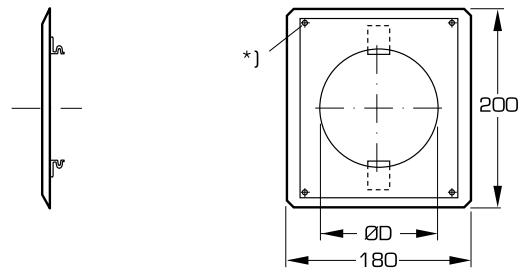

*) Holes (Ø4 mm) 15 mm from the edges.

Size	D [mm]	Weight [kg]
100	100	0.20
125	125	0.20

Used to replace earlier types of valves by KGEB-100 and KGEB-125 respectively.

Mounting frame KGEZ-20

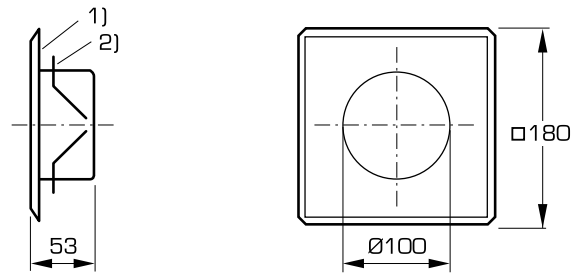

1 = Seal

2 = Spring

Weight 0.3 kg.

Used when old KGD valves are replaced with KGEB-100 or KGFC-1-010.

General

Application

The KGEB exhaust valve is suitable for use in all type of air treatment installation. The valve can be wall or ceiling mounted and the air flow is easy to adjust. KGEB has a low noise level, even if the pressure drop is high, and it has good natural sound attenuation. The valve has accessories adapted to different kinds of installations. Exhaust valves in sizes 125 and 160 fit renovation constructions in older KGEZ branches in equivalent sizes.

Material and surface finish

The valve is made of hot galvanized steel sheet.

It is powder coated for a high surface finish and good impact and scratch resistance.

Standard colour is white (RAL 9010). CleanVent coating as standard.

Instructions

Instructions for installation, adjustment and maintenance are described in detail in our technical instructions, also available on the Internet at: www.flaktgroup.com.

Technical data and dimensioning

For complete dimensioning details, please see FläktGroup product selection program.

Contact our nearest sales office for further information.

Packing

Delivery in cartons containing 10 pc.

Descriptive text

KGEB exhaust valve manufactured by FläktGroup in size 100, with fit-on type mounting ring/insertion type mounting ring/angle duct.

Product code

Exhaust valve

KGEB-aaa-b

Size (aaa)

100, 125, 160

Surface finish (b)

C = Standard CleanVent coating

E = Special colour

Accessories and spare parts

Accessories

Mounting ring, insertion connection KGEZ-01-aaa

Mounting ring, fit-on connection KGEZ-05-aaa
Size (aaa)
 100, 125, 160

Mounting frame KGEZ-12-aaa
Size (aaa)
 100, 125

Mounting frame (for old KGD frames) KGEZ-20

Angle duct KGEZ-43-aaa-bbb
Size (aaa-bbb)
 Connection diameter in mm to valve - to duct
 100-080, 100-100, 125-080, 125-100

Spare parts

Seal COGZ-aaa-4

Spring COSZ-aaa-1

Size (aaa)
 100, 125, 160